

FOR LEASE

Office Space Available
4838 Holly Road, Corpus Christi, TX 78411



Available:
Lease Rate:
Comments:

Several suites available. See attached floor plans.
\$1.25-\$1.40/SF Full Service
Professional office space conveniently located in Corpus Christi's growing South Side. The South Side of Corpus Christi is the fastest growing area in town and has easy access to the airport. With the retail and residential growth this may be considered the center of town. Ease of ingress and egress to SPID makes this office building within very close proximity to numerous restaurants and child care options. Unreserved surface parking.

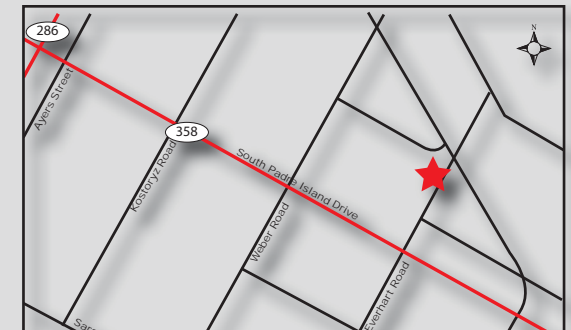

Joe Adame & Associates, Inc.
FULL SERVICE COMMERCIAL & INDUSTRIAL REAL ESTATE

www.joeadame.com

For more information please contact:

Chris Adame, CCIM
361-880-5888
chris@joeadame.com

Full Service Commercial and Industrial Real Estate

◆ Land ◆ Retail ◆ Industrial ◆ Investment ◆ Office

The information contained herein has been obtained from sources we deem reliable. We have no reason to doubt its accuracy, but we do not guarantee it.

FOR LEASE

4838 Holly Road, Corpus Christi, TX 78411

Floor Plans Building 1

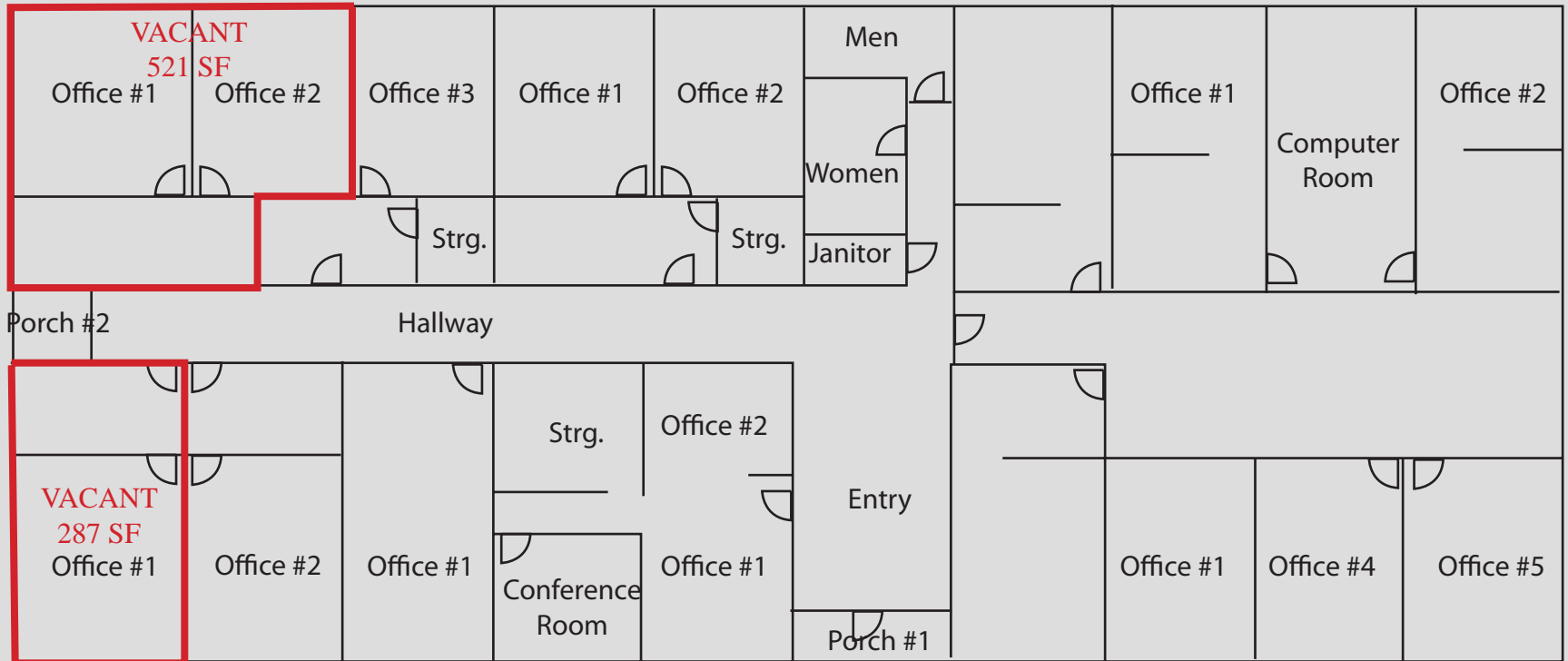

For more information please contact:

Chris Adame, CCIM

361-880-5888

chris@joeadame.com



Joe Adame & Associates, Inc.

www.joeadame.com

4550 Corona Drive, Corpus Christi, Texas 78411 Phone: 361-880-5888 Fax: 361-880-5883 www.joeadame.com

FOR LEASE

4838 Holly Road, Corpus Christi, TX 78411

Floor Plans Building 2

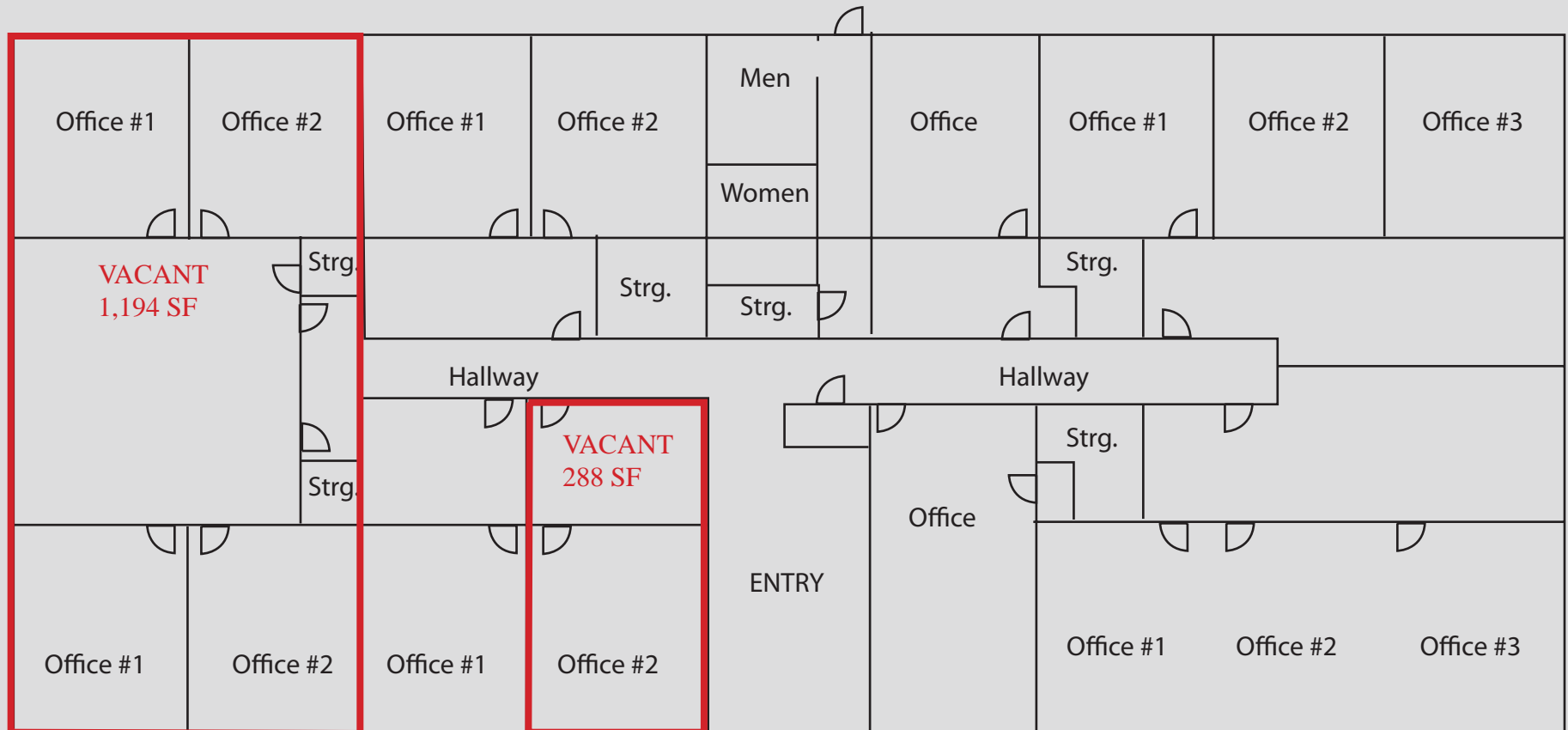

For more information please contact:

Chris Adame, CCIM
361-880-5888
chris@joeadame.com



Joe Adame & Associates, Inc.

www.joeadame.com

4550 Corona Drive, Corpus Christi, Texas 78411 Phone: 361-880-5888 Fax: 361-880-5883 www.joeadame.com

FOR LEASE

4838 Holly Road, Corpus Christi, TX 78411



For more information please contact:

Chris Adame, CCIM

361-880-5888

chris@joeadame.com



Joe Adame & Associates, Inc.

www.joeadame.com

4550 Corona Drive, Corpus Christi, Texas 78411 Phone: 361-880-5888 Fax: 361-880-5883 www.joeadame.com